

## **SEMIFUSE® SFLRDP Series PTC Re-settable Fuses**

Our SFLRDP strap fuse will provide non-cycling protection against short circuits. SFLRDP fuses are smaller, of lower resistance and offer a faster trip time than standard strap PTC fuses making them ideal for the latest generation of re-chargeable battery designs.

### **Characteristics**

Part #	I <sub>hold</sub> (A)	I <sub>trip</sub> (A)	V <sub>max</sub> (Vdc)	I <sub>max</sub> (A)	P <sub>d</sub> <sup>max</sup> (W)	Maximum Time to Trip @ 20°C		Resistance @ 20°C		Maximum Dimension (mm)	
						Current (A)	Time (Sec.)	R <sub>min</sub> (Ω)	R <sub>1max</sub> (Ω)	A	B
SFLRDP190F	1.90	3.9	15	100	1.2	9.50	5.0	0.039	0.102	22.1	5.5
SFLRDP260F	2.60	5.8	15	100	2.5	13.0	5.0	0.020	0.063	23.1	5.5
SFLRDP380F	3.80	8.3	15	100	2.5	19.0	5.0	0.013	0.037	26.0	7.5
SFLRDP450F	4.50	8.9	20	100	2.5	22.5	5.0	0.011	0.028	26.0	10.5
SFLRDP550F	5.50	10.5	20	100	2.8	27.5	5.0	0.009	0.022	37.0	7.5
SFLRDP600F	6.00	11.7	20	100	2.8	30.0	5.0	0.007	0.019	26.0	14.5
SFLRDP730F	7.30	14.1	20	100	3.3	30.0	5.0	0.006	0.015	29.1	14.5
SFLRDP900F	9.00	16.7	20	100	3.3	45.0	5.0	0.006	0.014	47.6	8.5
SFLRDP1000F	10.00	19.0	20	100	3.3	50.0	5.0	0.004	0.013	52.0	8.5

**Note** SFLRDP190F & SFLRDP260F devices are available with one slit strap on request.

**Agency Approvals;** UL, CSA and TÜV

### **Definitions**

I<sub>hold</sub> = Hold Current, maximum current device will pass without tripping in 20°C still air.

I<sub>trip</sub> = Trip Current, minimum current at which the device will trip in 20°C still air.

V<sub>max</sub> = Maximum Voltage device can withstand without damage at rated current (I<sub>max</sub>)

I<sub>max</sub> = Maximum fault current device can withstand without damage at rated voltage (V<sub>max</sub>)

### **Thermal De-rating curve**

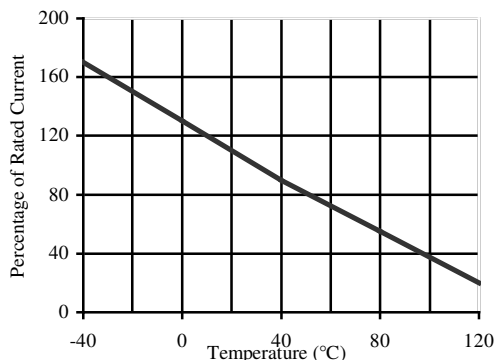

### **Configuration**

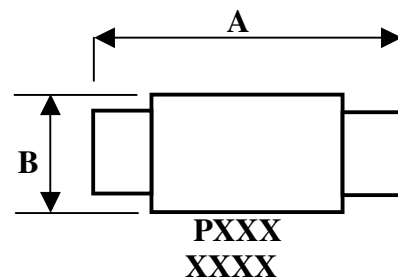

Dimensions – see above table

**CAUTION:** Operation beyond the specified maximum ratings may result in device damage and cause possible arcing and flame.