

SEMIFUSE® SFS0805F PTC Fuses

The SFS0805F series of PTC fuses is the smallest in our SMD range. It offers a surface mount solution for motherboard, computer peripheral and other electronic applications. The 0805 footprint can handle currents up to 1A and voltages up to 15V.

Characteristics

Approvals; UL, CSA & TÜV

Part Number	I_{hold} (A)	I_{trip} (A)	V_{max} (dc)	I_{max} (A)	P_d^{max} (W)	Maximum time to trip @ 23°C		Resistance @ 23°C		Maximum Dimension (mm)	
						Current (A)	Time (s)	R_{min} (Ω)	R_{1max} (Ω)	A	B
SFS0805F010TF	0.10	0.30	15	100	0.5	0.50	1.50	0.700	6.000	2.30	1.50
SFS0805F020TF	0.20	0.50	9	100	0.5	8.00	0.02	0.400	3.500	2.30	1.50
SFS0805F035TF	0.35	0.75	6	100	0.5	8.00	0.10	0.250	1.200	2.30	1.50
SFS0805F050TF	0.50	1.00	6	100	0.5	8.00	0.10	0.150	0.850	2.30	1.50
SFS0805F075TF	0.75	1.50	6	40	0.6	8.00	0.20	0.090	0.350	2.30	1.50
SFS0805F100TF	1.00	1.95	6	40	0.6	8.00	0.30	0.060	0.210	2.30	1.50

Definitions

I_{hold} = Hold current - maximum current PTC will pass without tripping in 23°C still air

I_{trip} = Trip current - minimum current at which the PTC will trip in 23°C still air

V_{max} = Maximum voltage PTC can withstand without damage at rated current (I_{max})

I_{max} = Maximum fault current PTC can withstand without damage at rated voltage (V_{max})

Thermal de-rating curve

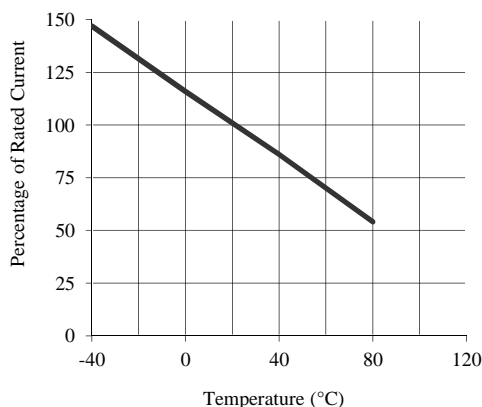

Configuration

SFS0805F Dimensions

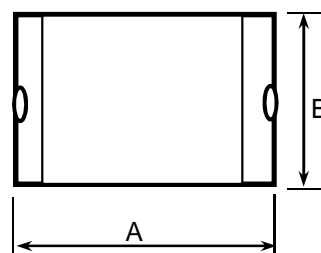

Solder Pad Layout

