

SEMIFUSE® SFS1210F PTC Fuses

The SFS1210F series of PTC fuses offers a surface mount solution for motherboard, computer peripheral and other electronic applications. This footprint can handle currents up to 2A and voltages up to 60V.

Characteristics

Approvals; UL, CSA & TÜV

Part Number	I_{hold} (A)	I_{trip} (A)	V_{max} (dc)	I_{max} (A)	P_d^{max} (W)	Maximum time to trip @ 23°C		Resistance @ 23°C		Maximum Dimension (mm)	
						Current (A)	Time (s)	R_{min} (Ω)	R_{1max} (Ω)	A	B
SFS1210F005TF	0.05	0.15	60	10	0.6	0.25	3.00	3.600	50.0	3.43	2.80
SFS1210F010TF	0.10	0.25	60	10	0.6	0.50	1.50	1.600	15.0	3.43	2.80
SFS1210F020TF	0.20	0.40	30	10	0.6	8.00	0.02	0.800	5.00	3.43	2.80
SFS1210F035TF	0.35	0.70	16	40	0.6	8.00	0.20	0.320	1.30	3.43	2.80
SFS1210F050TF	0.50	1.00	16	40	0.6	8.00	0.10	0.250	0.90	3.43	2.80
SFS1210F075TF	0.75	1.50	8	40	0.6	8.00	0.10	0.130	0.40	3.43	2.80
SFS1210F110TF	1.10	2.20	6	100	0.8	8.00	0.30	0.060	0.21	3.43	2.80
SFS1210F150TF	1.50	3.00	6	100	0.8	8.00	0.50	0.040	0.11	3.43	2.80
SFS1210F175TF	1.75	4.00	6	100	0.8	8.00	0.60	0.020	0.08	3.43	2.80
SFS1210F200TF	2.00	4.00	6	100	0.8	8.00	1.00	0.015	0.07	3.43	2.80

Definitions

- I_{hold} = Hold current - maximum current PTC will pass without tripping in 23°C still air
- I_{trip} = Trip current - minimum current at which the PTC will trip in 23°C still air
- V_{max} = Maximum voltage PTC can withstand without damage at rated current (I_{max})
- I_{max} = Maximum fault current PTC can withstand without damage at rated voltage (V_{max})

Thermal de-rating curve

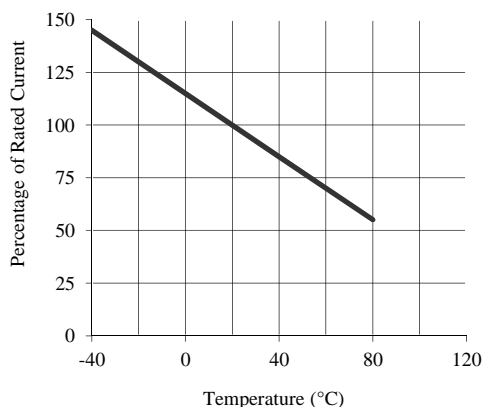

Configuration

SFS1210F Dimensions

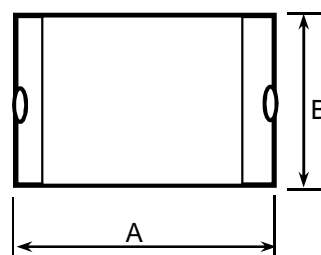

Solder Pad Layout

