

SEMIFUSE® SFS1210P PTC Fuses

The SFS1210P series of PTC fuses offers a surface mount solution for motherboard, computer peripheral and other electronic applications. This footprint can handle currents up to 2A and voltages up to 30V.

Characteristics

Approvals; UL, CSA & TÜV

Part Number	I_{hold} (A)	I_{trip} (A)	V_{max} (dc)	I_{max} (A)	P_d^{max} (W)	Maximum time to trip @ 20°C		Resistance @ 20°C		Maximum Dimension (mm)	
						Current (A)	Time (s)	R_{min} (Ω)	R_{1max} (Ω)	A	B
SFS1210P005TF	0.05	0.15	30	10	0.6	0.25	1.50	3.60	50.00	3.43	2.80
SFS1210P010TF	0.10	0.30	30	10	0.6	0.50	1.50	1.60	15.00	3.43	2.80
SFS1210P020TF	0.20	0.40	30	10	0.6	8.0	0.02	0.80	5.00	3.43	2.80
SFS1210P035TF	0.35	0.70	6	100	0.6	8.0	0.20	0.32	1.30	3.43	2.80
SFS1210P050TF	0.50	1.00	13.2	100	0.6	8.0	0.05	0.25	0.90	3.43	2.80
SFS1210P075TF	0.75	1.50	6	100	0.6	8.0	0.10	0.13	0.40	3.43	2.80
SFS1210P110TF	1.10	2.20	6	100	0.6	8.0	0.20	0.06	0.21	3.43	2.80
SFS1210P150TF	1.50	3.00	6	100	0.8	8.0	0.50	0.04	0.11	3.43	2.80
SFS1210P175TF	1.75	3.50	6	100	0.8	8.0	0.60	0.02	0.08	3.43	2.80
SFS1210P200TF	2.00	4.00	6	100	0.8	8.0	1.00	0.015	0.07	3.43	2.80

Definitions

- I_{hold} = Hold current - maximum current PTC will pass without tripping in 20°C still air
 I_{trip} = Trip current - minimum current at which the PTC will trip in 20°C still air
 V_{max} = Maximum voltage PTC can withstand without damage at rated current (I_{max})
 I_{max} = Maximum fault current PTC can withstand without damage at rated voltage (V_{max})

Thermal de-rating curve

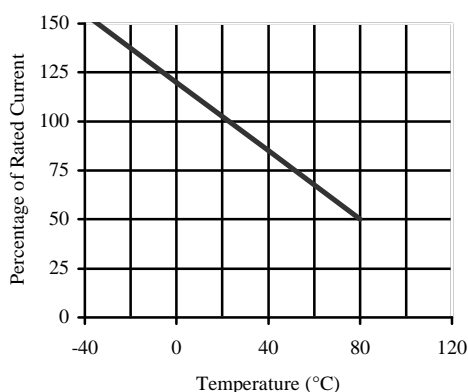

Configuration

SFS1210P Dimensions

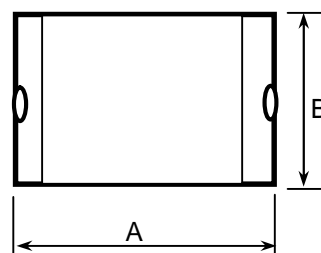

Solder Pad Layout

