

SEMIFUSE® SFS2016P PTC Fuses

The SFS2016P series of PTC fuses is our smallest in our SMD range. It offers a surface mount solution for motherboard, computer peripheral and other electronic applications. The 2016 footprint can handle continuous currents up to 2A and voltages up to 60V.

Characteristics

Approvals; UL, CSA & TÜV

Part Number	I_{hold} (A)	I_{trip} (A)	V_{max} (dc)	I_{max} (A)	P_d^{max} (W)	Maximum time to trip @ 20°C		Resistance @ 20°C		Maximum Dimension (mm)	
						Current (A)	Time (s)	R_{min} (Ω)	R_{1max} (Ω)	A	B
SFS2016P030TF	0.30	0.60	60	20	1.40	1.50	3.00	0.500	2.300	5.44	4.43
SFS2016P050TF	0.55	1.10	60	20	1.40	2.50	5.00	0.200	1.000	5.44	4.43
SFS2016P100TF	1.10	2.20	15	40	1.40	8.00	0.50	0.100	0.400	5.44	4.43
SFS2016P100TF/33	1.10	2.20	33	40	1.40	8.00	0.50	0.100	0.400	5.44	4.43
SFS2016P150TF	1.50	3.00	15	40	1.40	8.00	1.00	0.070	0.180	5.44	4.43
SFS2016P200TF	2.00	4.20	6	40	1.40	8.00	3.00	0.048	0.100	5.44	4.43

Definitions

I_{hold} = Hold current - maximum current PTC will pass without tripping in 20°C still air

I_{trip} = Trip current - minimum current at which the PTC will trip in 20°C still air

V_{max} = Maximum voltage PTC can withstand without damage at rated current (I_{max})

I_{max} = Maximum fault current PTC can withstand without damage at rated voltage (V_{max})

Thermal de-rating curve

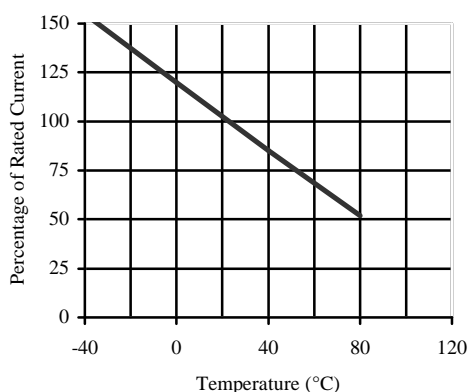

Configuration

SFS2016P Dimensions

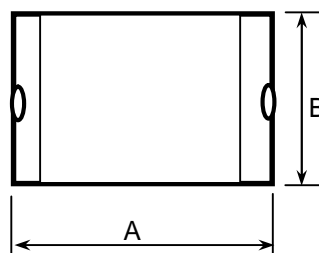

Solder Pad Layout

