

SEMIFUSE® SFVTDP Series PTC Re-settable Fuses

The SFVTDP strap fuse provides non-cycling protection against short circuits and offers the user a slim, low profile design with low resistance. This makes the SFVTDP an ideal choice for the latest generation of smaller rechargeable batteries, both cylindrical and prismatic.

Characteristics

Part #	I _{hold} (A)	I _{trip} (A)	V _{max} (Vdc)	I _{max} (A)	P _d ^{max} (W)	Maximum Time to Trip @ 20°C		Resistance @ 20°C		Maximum Dimension (mm)	
						Current (A)	Time (Sec.)	R _{min} (Ω)	R _{1max} (Ω)	A	B
SFVTDP170F	1.70	3.4	15	100	1.4	8.50	3.0	0.030	0.105	17.5	7.4
SFVTDP175F	1.75	3.8	15	100	1.4	9.00	3.0	0.025	0.090	22.2	3.8
SFVTDP200F	2.00	4.5	15	100	1.5	10.0	4.0	0.021	0.080	23.1	4.3
SFVTDP210F	2.10	4.7	15	100	1.5	10.0	5.0	0.018	0.060	23.1	5.3
SFVTDP240F	2.40	5.4	15	100	1.5	12.0	4.0	0.015	0.052	26.2	5.3

Note Some variants available with one slit strap, double slits or longer format on request.

Agency Approvals; UL, CSA and TÜV

Definitions

- I_{hold} = Hold Current, maximum current device will pass without tripping in 20°C still air.
- I_{trip} = Trip Current, minimum current at which the device will trip in 20°C still air.
- V_{max} = Maximum Voltage device can withstand without damage at rated current (I_{max})
- I_{max} = Maximum fault current device can withstand without damage at rated voltage (V_{max})

Thermal derating curve

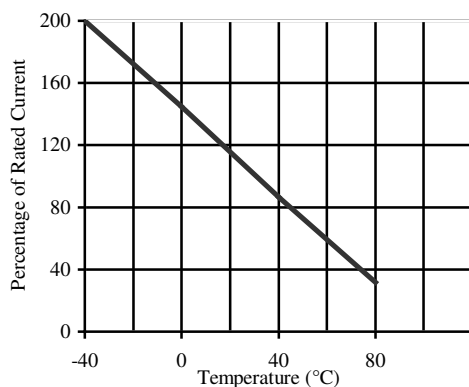

Configuration

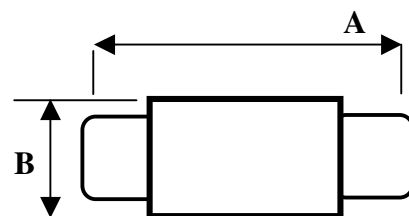

PXXX
 XXXX

Dimensions – see above table

CAUTION: Operation beyond the specified maximum ratings may result in device damage and cause possible arcing and flame.